



Future Projects Discussion

Deferred Projects

B4/B5 Elevator	Accessibility Upgrade to Existing Buildings, Elevator and Sloping Walks	7,575 NSF
Sci/Math Building Renovation for Allied Health	Allied Health Instruction Labs & Office Suite	3,500 SF
Science Center Rénovation	Mail Room & Reprographics	
Renovation - Omni-Acoustical Perf Lab	Upgrade (e) performance space	
Heldman Learning Resource Center Reno-Phase	Learning Center Expansion, Digital Library, Library Orientation Room and Office Suites	16,800 NSF
Career Education Renovation	Associated Student Organization, Student Lounge Student Health Center, and Welcome Center	27,850 NSF
Demo Temp & Obsolete Facilities - Building B1		
Demo Temp & Obsolete Facilities - Building A9		
Demolition - Buildings B6, B4, B5		

MS-A Renovation

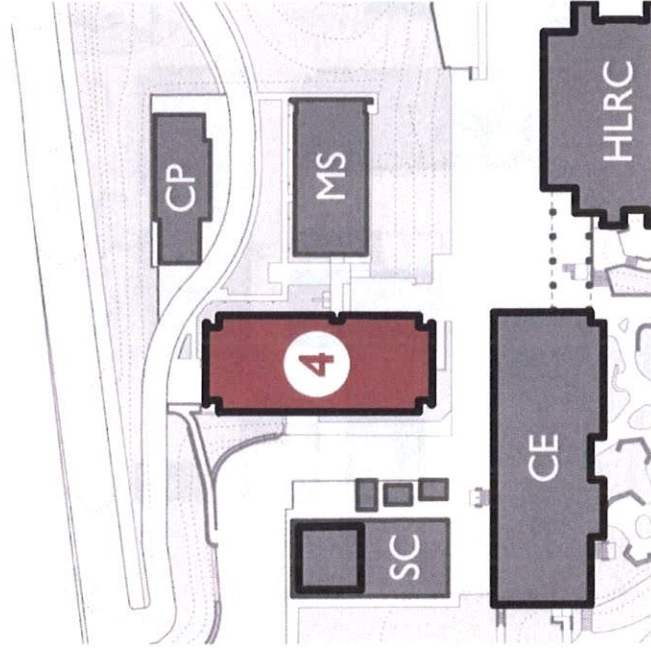

COST ESTIMATE: \$2.13 M

PROJECT SCOPE

- 2,200 square foot renovation on ground level of existing 'MS-A' Building:
 1. Remove interior partitions separating existing Rooms A010, A011, and A013.
 2. Provide new interior partition, patch ceiling and finishes, re-configure light fixtures, HVAC equipment, and fire sprinkler heads, as required to convert space into (2) 1,000 square foot Classrooms.
 3. Alter corridor-adjacent wall as required to provide access to renovated spaces.
- 5,375 square foot renovation on 1st level of existing 'MS-A' Building:
 1. Remove interior partition separating existing Rooms A109 & A112.
 2. Provide new interior partitions, patch ceilings and finishes, and re-configure light fixtures, HVAC supply & return outlets, sprinkler heads and other FLS systems, to provide Allied Health Division offices.
 3. Install new light fixtures, power & data, and electrical outlets for new office layout.
 4. Install stand-alone HVAC system to service office space and allow the rest of the MS-A Building to be shut-down during Summer and Winter terms.
 5. Remove interior partitions separating existing Rooms A102, A104, A105, and A106.
- Provide new interior partitions, patch ceilings and finishes, re-configure light fixtures, HVAC equipment, and sprinkler heads and other FLS systems, as required to provide proposed Allied Health Lab, Mock Medical Lab and dedicated storage for the Allied Health Division.

SC Renovation

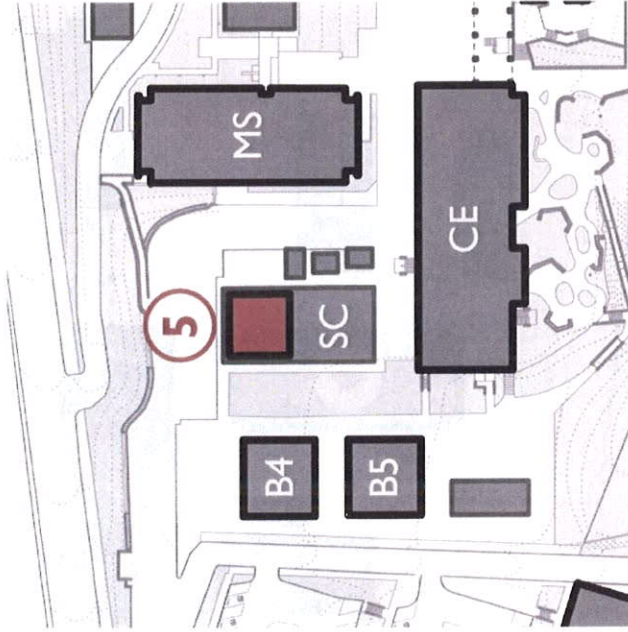

COST ESTIMATE: \$0.94 M

PROJECT SCOPE

- 3,500 square foot renovation on East side of existing 'SC' Building.
 1. Remove interior partitions separating existing Rooms 102, 103, and 104.
 2. Remove existing casework in Room 101.
 3. Expand existing opening through envelope into Room 103 on the South side of the building to accommodate a larger entry door.
 4. Patch/repair existing finishes, re-configure light fixtures, HVAC equipment, and sprinkler heads and other FLS systems, and provide new casework, as required to provide proposed Mailroom in existing Room 101.
 5. Provide new interior partitions, patch ceilings and finishes, re-configure light fixtures, HVAC equipment, and sprinkler heads and other FLS systems, as required to provide proposed Reprographics room and Faculty/Staff Workroom.

3. OMNI ACOUSTICAL SPACE

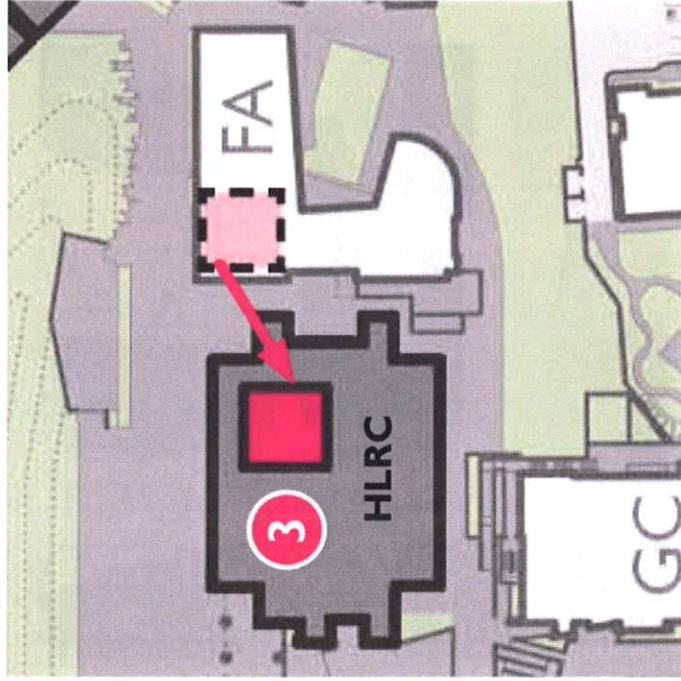

PROJECT RELOCATED

REASONS FOR RELOCATION

- The new location is the existing space for the program. It is more cost effective not to relocate the program.